

CHALLENGES

- Minimize potential for the harboring of bacteria due to grout or porosity.
- A durable shower pan that is easily maintained.
- A shower pan that can be installed with out membrane.
- Non-porous grout free shower pan.

SOLUTION

- Grifform Innovations® custom certified shower pans in DuPont™ Corian®.
- Grifform Innovations® Shower Pans designed with your space and specifications applied, in your choice of over 100 DuPont™ Corian® colors.

RESULTS

- A certified shower base that meets your challenge.
- A Grifform Innovations® Shower Pan that is fully supported by structural fire retardant foam.
- Grifform Innovations® bases are built in a wide pallet of DuPont™ Corian® color options as defined by your project designer.
- Grifform Innovations® shower base built to your specific drain location.
- Meets the durability and renewability requirements.
- Seamless beauty of nonporous DuPont™ Corian®.

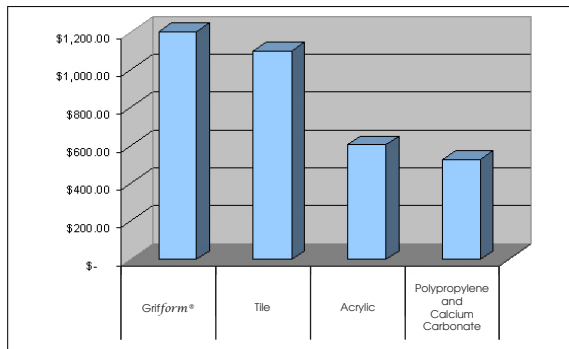

ATTRIBUTED VALUE OF THE GRIFFORM® CUSTOM PANS

- Custom size and configuration
- Custom drain location
- Requires no liner
- Installed quickly and easily
- Seamless application (no grout)
- Class 1/A fire rated
- Available in most DuPont™ Corian® colors
- Lower maintenance cost
- DuPont™ Corian® can help earn points for LEED program
- Extended life cycle
- Slip resistance available

Policies

Order Policy: All Purchase Orders need to be made with attention to specified lead times necessary to produce the specified product. All Rush Orders are subject to additional 35% charge per item if outside the prescribed lead times. If a Rush Order status is prescribed and delivery on regular schedule is not acceptable any deviation from the normal schedule will be at additional packaging and shipping charge to the customer, as applicable.

Receiving/Acceptance Policy: If the product is as ordered, but the order has been incorrectly placed it shall be the full responsibility of the purchasing agency to accept and make payment on the item as per purchase order agreement. The replacement of the item will be handled as a new purchase order with the established lead times and regular delivery schedule for that particular product.

Return Policy: If the receiver discovers a manufacturer defect due to material or workmanship, notification needs to be made within 72 hours of receipt and the process for return shall be as follows: The product is to be returned fully and properly packed in original packaging to insure no damage is incurred to the product. After inspection is made and determined that the part has not been manufactured according to Grifform Innovations® standard we will replace or repair the part at our discretion.

Because all parts Grifform Innovations® produces for the purchasing agency are built to order, repair or replacement orders may require additional time to process. A Return Authorization Number is required to process a return. This number can be acquired by written notice from the purchasing agency. In the written notice we require the purchasing agency's PO Number, Part Number, item description, date received, and the noted defect. For a return credit to be considered the product will be returned fully and properly packed in its original packaging so as to ensure no damage is done to the product.

Grifform Innovations® does not give assurance that dye lots will match other sheet good products and/or that the process might not change these characteristics.

Please visit www.Grifform.com
for additional product information.

Grifform Innovations®
PO Box 258 Glide, OR 97443
541-496-0313 SJCP-1-10

Custom Shower Pans



Distinctive Excellence



The miracles of science



Grifform Innovations® offers custom shower pans made of durable solid surface material. We build custom drain locations as well as threshold or ADA entrances to meet your specific need. We will apply a slip resistant, engineered finish to further aid in the safety of your shower floor. The base is fully supported with fire retardant structural foam. There is no need for a rubber membrane or mud-set for the base to be installed. We have complete instructions to aid in the ease of installation. Your order is confirmed with drawings to assure our products are made according to the specification that meet both plumbing requirements, ADA requirements if they apply, and the requirements specific for your project. Grifform Innovations® shower pans are certified by NAHB Research Center.

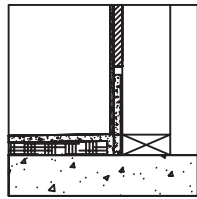

STRAIGHT WALL
1/4" OR 1/2" WALLS

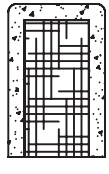

NO DRIP THRESHOLD
CROSS SECTION

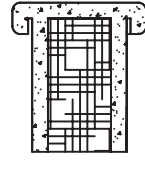

DRIP THRESHOLD
CROSS SECTION

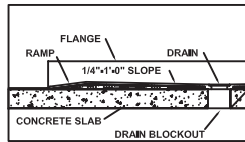

LOW EGRESS THRESHOLD OPTION

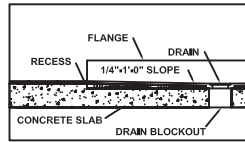

NO EGRESS THRESHOLD OPTION

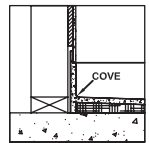

COVED WALL
OPTION #1
1/2" WALLS

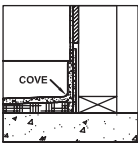

COVED WALL
OPTION #2
1/2" WALLS

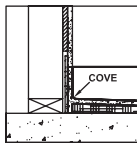

COVED WALL
OPTION #3
1/2" WALLS

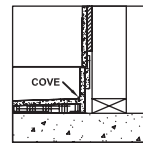

COVED WALL
OPTION #4
1/2" WALLS

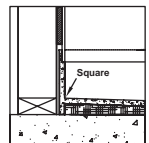

SQUARE WALL
OPTION #1
1/2" WALLS

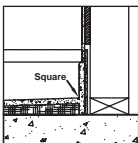

SQUARE WALL
OPTION #2
1/2" WALLS

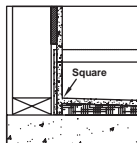

SQUARE WALL
OPTION #3
1/2" WALLS

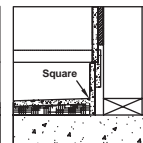

SQUARE WALL
OPTION #4
1/2" WALLS

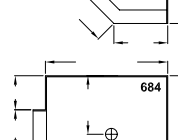
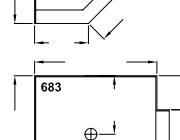
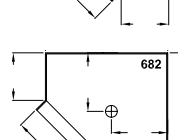
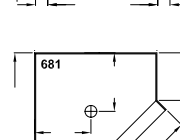
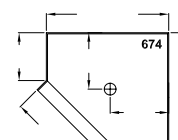
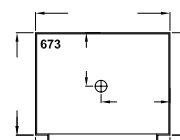
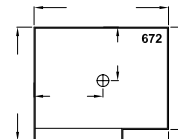
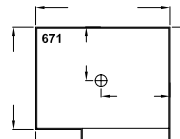
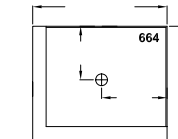
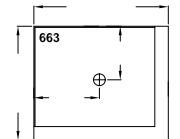
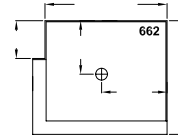
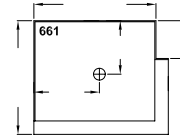
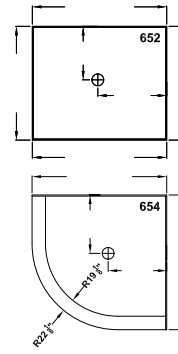
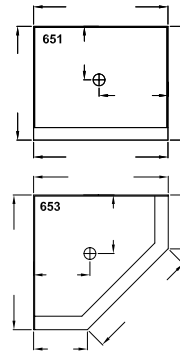

How to Measure a Custom Drain Location

1. Measure the distance from the out side of the shower pan wall to the center of the drain on the back and one side wall of the pan.
2. The center of the drain must be at least 10" from the shower pan walls.
3. The distance between the stud wall and the shower pan wall must be at least 1/8" to allow for shower pan expansion.
4. Make other adjustments based on the thickness of the wall material used.

WARRANTY

Grifform Innovations® warrants to the original purchaser that the product shall be free from defects in material, workmanship and manufacture for twelve months.

The original purchaser must convey the product to Grifform Innovations® at the purchasers' expense. If Grifform Innovations® agrees that the material and workmanship of the product was defective, Grifform Innovations® will repair or replace the product, at its option, and convey the repaired or new product to the purchaser at the expense of Grifform Innovations®.

Repair or replacement is the sole remedy provided by this warranty, and there are no warranties that extend beyond the description on the face hereof.

Grifform Innovations® EXPRESSLY DISCLAIMS ANY IMPLIED WARRANTY OF MERCHANTABILITY OR ANY IMPLIED WARRANTY OF FITNESS FOR A PARTICULAR PURPOSE.