

# WALL CLADDING -

DETERMINED TO IMPROVE YOUR ENVIRONMENT



Grifform Innovations® Wall Cladding Systems address both durability and design for your wall covering needs. The monolithic easily maintained wall panels, baseboards and rails, made of DuPont™ Corian® offer years of beauty and enjoyment to any healthcare facility.

## CHALLENGES

- Wall surfaces that are durable in an abusive environment.
- Wall surfaces that can withstand years of maintenance.
- A wall surfaces that is not just functional but brings a touch of design that is warm and inviting.
- Nonporous wall covering that minimizes germ growth.
- Wall cladding that is easy to order and install.

## SOLUTION

- The Grifform Innovations® Wall Cladding System using ¼" DuPont™ Corian® colors.
- The Grifform Innovations® Wall Cladding System meets all the challenges you face.

## RESULTS

- ¼" DuPont™ Corian® tongue and grooved wall panels available in 34" – 48" height and 96" lengths.
- Various trims, coves, and molding options to make the specific height or width for your application and design needs.
- Durable clean approach to achieve wall treatments that stand up to the rigorous healthcare environment.
- Meets AIA 2006 Surface Standards for healthcare applications.
- Easy order parts catalog.

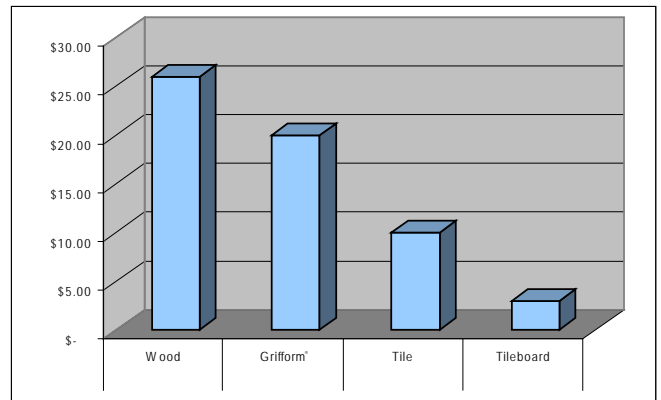

## ATTRIBUTED VALUE OF THE GRIFform® WALL CLADDING

- Tongue and groove application for a seamless look
- Installed quickly and easily
- Lower maintenance cost
- DuPont™ Corian® can help earn points for LEED program
- Extended life cycle
- Class 1/A fire rated



Grifform Innovations®  
Wall Cladding -  
Determined to improve your environment.

Grifform Innovations® offers you a beautiful solution to the tough challenge of creating durable and safe environments that meet the rigorous demands of healthcare. Our Wall-cladding system feature ¼" material of DuPont™ Corian® that are tongue and grooved panels and are available in 34" to 48" high and typically 96" in length. The top and bottom trim are offered in heights of 2 ¾", 3 ¾", or 5 ¾" and 96" lengths with a 5/8" rabbet joint. All vertical trims are in ½" material either 3 ¾" or 4 ½" widths, either 48" or 96" lengths. Choose Grifform Innovations® Wall Cladding for a durable clean approach to achieve wall treatments that stand up to the rigorous healthcare environment and also meet the AIA 2006 Surface Standards. For ease in ordering please refer to our parts catalog. Coved and straight base boards are offered in ¼" material in four heights from 2 ¾" to 5 ¾" by 96" length, and ½" is available 96" and 144" lengths in the same height options. In addition, kick plates and push plates are available to protect your doors. Your ability to keep the theme of color through out, and the convenience of care using DuPont™ Corian® bring added value to your project.

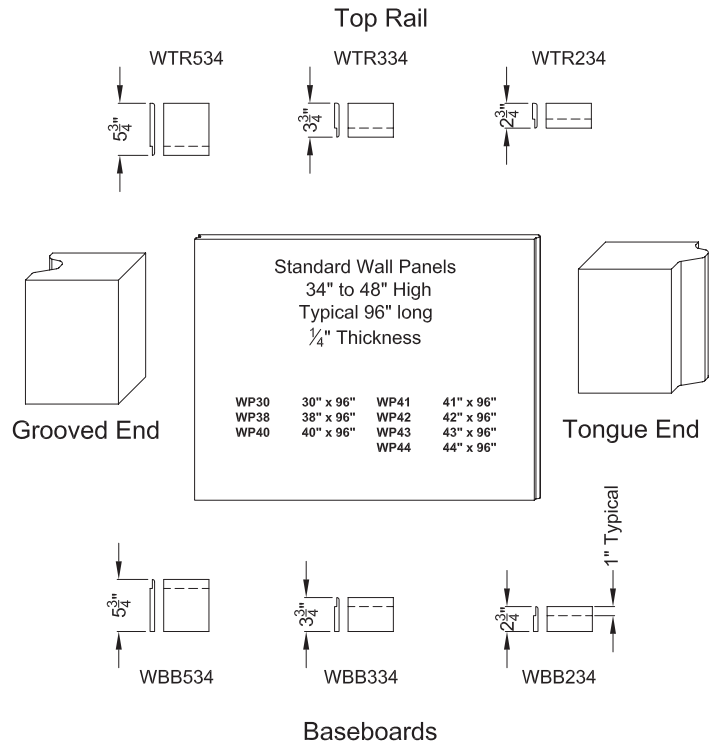

The Wall Cladding height is a combination of the panel height plus the combined heights of the top rail and the baseboard.

Example: Large Baseboard and Top Cap =  $5\frac{3}{4} + 5\frac{3}{4} + 36\frac{1}{2} = 48$ "  
(38" Panel =  $36\frac{1}{2}$ " exposed height plus  $1\frac{1}{2}$ " concealed height)

A regular 30" high panel will make Wall Cladding from 34" to 40" high.

A standard 38" high panel will make Wall Cladding from 42" to 48" high.

Panels over 30" high are all factory seamed panels.

Ends of the panels are tongue and grooved for end to end field seams to make panels to 24 feet long before a mullion (expansion joint) is recommended.

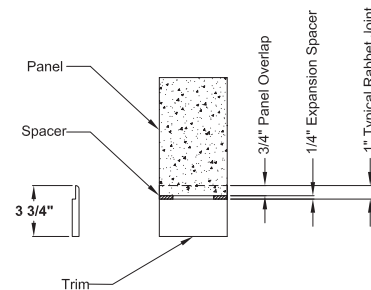

### Grifform Innovations® In Healthcare

Grifform® offers nearly a hundred healthcare-related products. Each is designed to solve a specific challenge or problem. Of the many products we offer, pay particular attention to the Grifform Innovations® Privacy Partitions. Each feature the winning combination of solid surface suitability for healthcare and Grifform® innovation.

*All data given herein is believed to be accurate but is presented without guaranty or warranty.*