

## CHALLENGES

- Minimize potential for the harboring of bacteria due to grout or porosity.
- A durable shower pan that is easily maintained.
- A shower pan that can be installed with out membrane.
- Non-porous grout free shower pan.

## SOLUTION

- *Grifform Innovations*<sup>®</sup> Classic certified shower pans in DuPont<sup>™</sup> Corian<sup>®</sup>.
- *Grifform Innovations*<sup>®</sup> Shower Pans designed with your space and specifications applied, in your choice of over 100 DuPont<sup>™</sup> Corian<sup>®</sup> colors.

## RESULTS

- A certified shower base that meets your challenge.
- A *Grifform Innovations*<sup>®</sup> Shower Pan that is fully supported by structural fire retardant foam.
- *Grifform Innovations*<sup>®</sup> bases are built in a wide pallet of DuPont<sup>™</sup> Corian<sup>®</sup> color options as defined by your project designer.
- *Grifform Innovations*<sup>®</sup> shower base that can be built to your specific drain location.
- Meets the durability and renewability requirements.
- Seamless beauty of nonporous DuPont<sup>™</sup> Corian<sup>®</sup>.

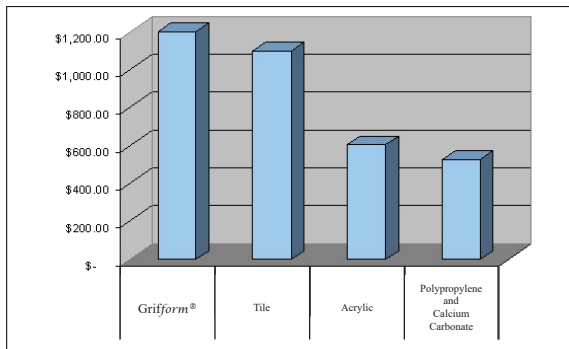

## ATTRIBUTED VALUE OF THE GRIFform<sup>®</sup> CUSTOM PANS

- Custom drain location available
- Requires no liner
- Installed quickly and easily
- Seamless application ( no grout )
- Class 1/A fire rated
- Available in most DuPont<sup>™</sup> Corian<sup>®</sup> colors
- Lower maintenance cost
- DuPont<sup>™</sup> Corian<sup>®</sup> can help earn points for LEED program
- Extended life cycle
- Slip resistance available

## Policies

**Order Policy:** All Purchase Orders need to be made with attention to specified lead times necessary to produce the specified product. All Rush Orders are subject to additional 35% charge per item if outside the prescribed lead times. If a Rush Order status is prescribed and delivery on regular schedule is not acceptable any deviation from the normal schedule will be at additional packaging and shipping charge to the customer, as applicable.

**Receiving/Acceptance Policy:** If the product is as ordered, but the order has been incorrectly placed it shall be the full responsibility of the purchasing agency to accept and make payment on the item as per purchase order agreement. The replacement of the item will be handled as a new purchase order with the established lead times and regular delivery schedule for that particular product.

**Return Policy:** If the receiver discovers a manufacturer defect due to material or workmanship, notification needs to be made within 72 hours of receipt and the process for return shall be as follows: The product is to be returned fully and properly packed in original packaging to insure no damage is incurred to the product. After inspection is made and determined that the part has not been manufactured according to *Grifform Innovations*<sup>®</sup> standard we will replace or repair the part at our discretion.

Because all parts *Grifform Innovations*<sup>®</sup> produces for the purchasing agency are built to order, repair or replacement orders may require additional time to process. A Return Authorization Number is required to process a return. This number can be acquired by written notice from the purchasing agency. In the written notice we require the purchasing agency's PO Number, Part Number, item description, date received, and the noted defect. For a return credit to be considered the product will be returned fully and properly packed in its original packaging so as to ensure no damage is done to the product.

*Grifform Innovations*<sup>®</sup> does not give assurance that dye lots will match other sheet good products and/or that the process might not change these characteristics.

## Classic Shower Pans



*Distinctive Excellence*

Please visit [www.Grifform.com](http://www.Grifform.com)  
for additional product information.

*Grifform Innovations*<sup>®</sup>

PO Box 258 Glide, OR 97443

541-496-0313

SJCP-3-17

**Griform Innovations®**  
Classic Shower Pans

Griform Innovations® offers Classic Shower Pans made of durable half inch solid surface material. For an additional fee we can build a custom drain location when needed. The threshold is our "no drip" threshold and there are no cove options for this shower pan. We can add a slip resistant, engineered finish to further aid in the safety of your shower floor. The base is fully supported with fire retardant structural foam. There is no need for a rubber membrane or mud-set for the base to be installed. We have complete instructions to aid in the ease of installation. Your order is confirmed with drawings to assure our products are made according to the specification that meet both plumbing requirements and the requirements specific for your project. Griform Innovations® shower pans are certified.

Drain location change fee is \$80.00

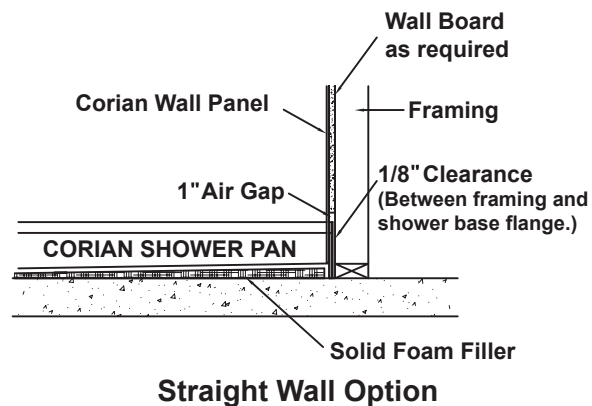
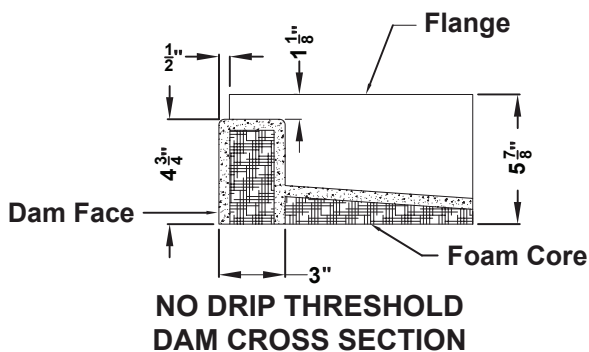

**Square/Rectangle Pan**

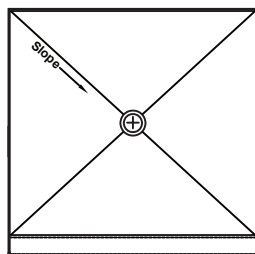

- Sizes
- 36" x 36"
  - 38" x 38"
  - 42" x 42"
  - 42" x 36"
  - 48" x 36"
  - 60" x 36"

Standard drain location is centered on each pan size

**Neo Angle Pan**

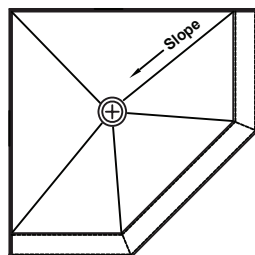

- Sizes
- 36" x 36"
  - 38" x 38"
  - 42" x 42"

Standard drain location is centered on each pan size

**Square Corner Pan**

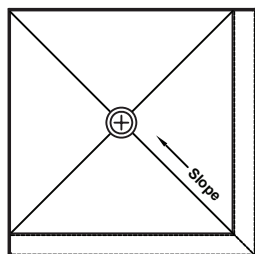

- Sizes
- 36" x 36"
  - 38" x 38"
  - 42" x 42"

Standard drain location is centered on each pan size.

**Tub Replacement**

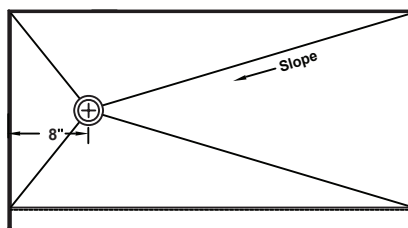

- Sizes
- 60" x 32"
  - 60" x 34"
  - 60" x 36"

Standard tub replacement available with left or right drain options.

**How to Measure a Custom Drain Location**

1. Measure the distance from the out side of the shower pan wall to the center of the drain on the back and one side wall of the pan.
2. The center of the drain must be at least 4" from the shower pan walls.
3. The distance between the stud wall and the shower pan wall must be at least 1/8" to allow for shower pan expansion.
4. Make other adjustments based on the thickness of the wall material used.



**WARRANTY**

Griform Innovations® warrants to the original purchaser that the product shall be free from defects in material, workmanship and manufacture for twelve months.

The original purchaser must convey the product to Griform Innovations® at the purchasers' expense. If Griform Innovations® agrees that the material and workmanship of the product was defective, Griform Innovations® will repair or replace the product, at its discretion, and convey the repaired or new product to the purchaser at the expense of Griform Innovations®.

Repair or replacement is the sole remedy provided by this warranty, and there are no warranties that extend beyond the description on the face hereof.

Griform Innovations® EXPRESSLY DISCLAIMS ANY IMPLIED WARRANTY OF MERCHANTABILITY OR ANY IMPLIED WARRANTY OF FITNESS FOR A PARTICULAR PURPOSE.